



PRODUCT CATALOG

# TABLE OF CONTENTS

Welcome .....	1-2
Diamond Difference .....	3-4
Quality Standard Features .....	5-6
Craftsman Collection .....	7-14
Classic Collection .....	15-18
Urban Collection .....	19-30
Base Standard Specifications Guide .....	31-33
Tall Cabinet Specifications Guide .....	34
Wall Cabinet Specifications Guide .....	35-40
Accessory & Molding Specifications Guide .....	41-44
Information-Disclaimer & General Care .....	45-46
Warranty & Returns .....	47-48
Customer Care .....	49-50

SPECIAL NOTE: Throughout this brochure, the product names are intended to evoke the color and style of the material only and are not intended to indicate or describe the materials used in cabinetry manufacturing.

© 2023 Innovation Cabinetry LLC. All Rights Reserved. No image or information published in this publication may be reproduced, transmitted or copied (other than for the purposes of fair dealing, as defined in the Copyright Act 1968) without the express written permission of Innovation Cabinetry, LLC.



# DESIGN

Innovation Cabinetry carefully crafts our selection of cabinetry using only the most desirable designs and colors. As a result, our cabinet collections are unsurpassed in their beauty, form, and function.

# QUALITY

Engineered using premium materials and constructed to the highest industry standards, we strive to provide quality you can trust. We proudly stand behind our products and your investment.

# SAFETY

While style and strength are essential, they are nothing without ensuring safety. Our products are Carb2 Compliant, meeting and exceeding strict standards set for formaldehyde emissions. As a family-owned business, we believe a healthy family is a happy family.

# INNOVATION CABINETRY

We are an American company headquartered in Tampa, Florida. We manufacture, source, and distribute high-quality cabinetry for designers, contractors, and builders. Our mission is to ensure our products are expertly crafted to last a lifetime.





# DIAMOND DIFFERENCE

Style, strength, and safety are the hallmarks of our Diamond Difference. We uphold these high standards to ensure the cabinets you receive are beautiful, functional, and will last a lifetime.

- 1 SUSTAINABLY SOURCED PREMIUM WOOD**  
Each piece of Innovation Cabinetry is constructed of premium wood legally harvested from certified forests. Sustainably sourced prime timber not only fulfills our commitment to quality materials but exemplifies our sense of responsibility to the environment. You can see the premium character in the natural, never-bleached surface of every cabinet we create.
- 2 A FINISH THAT'S COMPLETE**  
A performance or product is only complete once it has received that perfect finishing touch. From the faces of our cabinets to the matching interiors, every Innovation Cabinetry product receives our multi-step finishing process to ensure a beautiful, lasting surface for your home. We use the highest quality materials on the market, including Sherwin Williams paints, followed by a UV finish to prevent fading and provide superior scratch resistance.
- 3 CONCERN FOR YOUR HEALTH**  
Innovation Cabinetry designs our products with homeowners in mind. While style and strength are essential, they are nothing without ensuring your safety. Our products are CARB2 compliant, meaning they have met and exceeded the strict standards for formaldehyde emissions. We are continually refining our production process to provide the cleanest possible products for your home.
- 4 THE SOUND OF SILENCE**  
Sometimes the thing that matters the most is what's missing. With soft-close hinges and soft-close under-mount drawer glides, there won't be any slamming doors or rattling dishware. Our soft-close hardware uses natural oils to provide the effect instead of components easily broken after repeated uses. These superior hinges and glides are standard on all of our products.
- 5 IMPECCABLE STYLE, EXPANSIVE STORAGE**  
No matter which style of cabinet you choose, you'll be enjoying a frameless interior that provides more storage than standard framed cabinets. Drawer space is higher and deeper, and both base and wall cabinets provide 15% more storage space without the additional lip that framing requires.
- 6 QUALITY TESTED, THEN TESTED AGAIN**  
Without function, form is irrelevant. The functionality of our cabinets has been proven. Our soft-close glides have been tested over 50,000 times. Our 6-way adjustable hinges have been tested twice that many, the equivalent of two lifetimes of use.
- 7 STRENGTH OF SUBSTANCE AND STRUCTURE**  
Innovation Cabinetry believes in not just meeting standards but exceeding them. Our furniture-grade wood components are all 3/4", fifty percent thicker than the industry standard. We provide metal corner brackets to ensure strength and stability in all of our base cabinets. Dovetail joints, dado channels, and dowels offer security between interlocking parts and are a beautiful example of the exquisite craftsmanship behind our cabinetry.







# STANDARD FEATURES

Multi-layered finished doors have a solid wood frame and MDF center panel. MDF center panel minimizes expansion and contraction for minimal cracking.

Mortise and tenon door and drawer joints for robust and durable construction.

The 6-way adjustable soft-close hinges allow doors to close silently and smoothly.

3/4" thick plywood shelf has six finished sides and four metal shelf clips to withstand heavy items.

Full access frameless cabinets allow for ample storage.

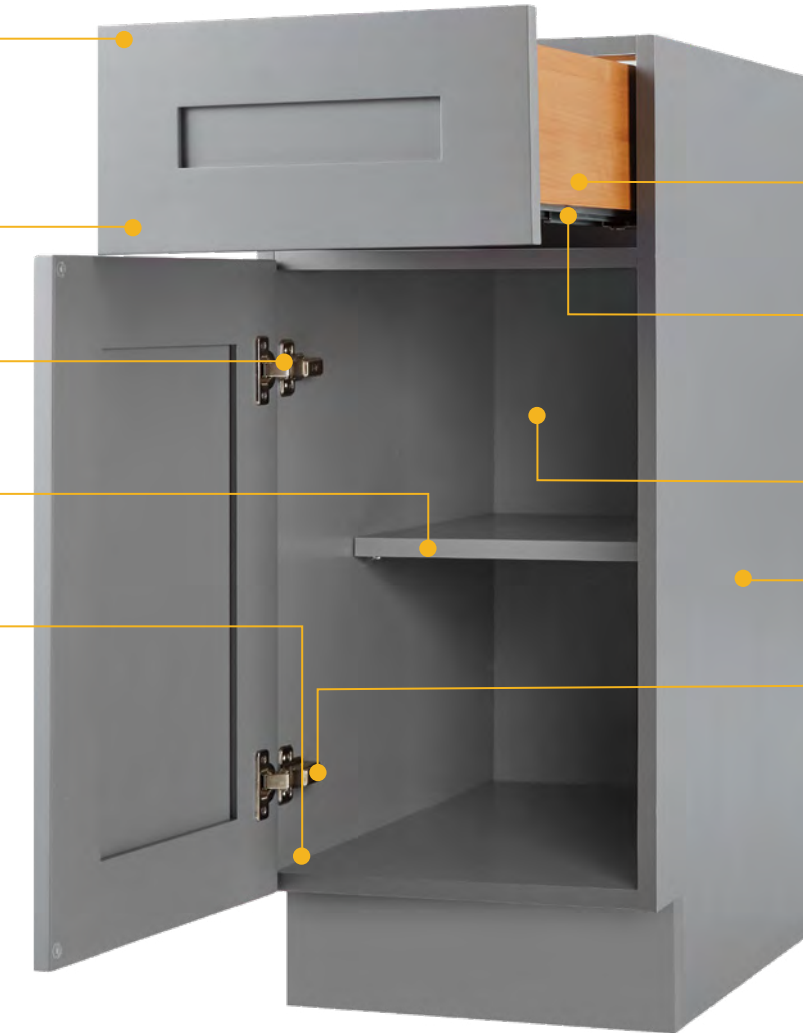

Interior metal support brackets reinforce corners and create a stable and long-lasting foundation.

Solid wood drawer construction with four corner dovetail joints, the strongest joints used in cabinetry.

Concealed under-mount drawer glides have full extension for easy access to the deepest part of the drawer.

Interior and exterior finishes match for a flawless look.

The 3/4" plywood box panel construction is 50% thicker than industry standards.

Concealed quick-release door hinges for swift and easy door removal for complete access.



KMCA compliant meets and exceeds high industry standards. See page 40 for more information.



Carb 2 compliant certified to meet reduced emission standards for a safe environment. See page 40 for more information.



## CRAFTSMAN COLLECTION SHAKER WHITE

- Shaker-style frameless cabinets with minimal detailing and a low profile
- Five-piece, solid wood frame doors have a robust mortise and tenon construction
- Solid wood drawers with dovetail joints
- Soft-close door and drawer mechanism
- 6-way adjustable hinges
- Concealed under-mount drawer glides with full extension
- 3/4" furniture-grade plywood construction
- Two interior metal corner supports on cabinet base
- Durable multi-layered painted drawer fronts and doors
- Matching interior and exterior finish
- Offered with a glass front option (glass and clips not included)
- Decorative trim and molding available, see pages 41-44





## CRAFTSMAN COLLECTION IMPERIAL BLUE

- Shaker-style frameless cabinets with minimal detailing and a low profile
- Five-piece, solid wood frame doors have a robust mortise and tenon construction
- Solid wood drawers with dovetail joints
- Soft-close door and drawer mechanism
- 6-way adjustable hinges
- Concealed under-mount drawer glides with full extension
- 3/4" furniture-grade plywood construction
- Two interior metal corner supports on cabinet base
- Durable multi-layered painted drawer fronts and doors
- Matching interior and exterior finish
- Offered with a glass front option (glass and clips not included)
- Decorative trim and molding available, see pages 41-44





## CRAFTSMAN COLLECTION STORM GRAY

- Shaker-style frameless cabinets with minimal detailing and a low profile
- Five-piece, solid wood frame doors have a robust mortise and tenon construction
- Solid wood drawers with dovetail joints
- Soft-close door and drawer mechanism
- 6-way adjustable hinges
- Concealed under-mount drawer glides with full extension
- 3/4" furniture-grade plywood construction
- Two interior metal corner supports on cabinet base
- Durable multi-layered painted drawer fronts and doors
- Matching interior and exterior finish
- Offered with a glass front option (glass and clips not included)
- Decorative trim and molding available, see pages 41-44





## CRAFTSMAN COLLECTION PEARL WHITE

- Shaker-style frameless cabinets with minimal detailing and a low profile
- Five-piece, solid wood frame doors have a robust mortise and tenon construction
- Solid wood drawers with dovetail joints
- Soft-close door and drawer mechanism
- 6-way adjustable hinges
- Concealed under-mount drawer glides with full extension
- 3/4" furniture-grade plywood construction
- Two interior metal corner supports on cabinet base
- Durable multi-layered painted drawer fronts and doors
- Matching interior and exterior finish
- Offered with a glass front option (glass and clips not included)
- Decorative trim and molding available, see pages 41-44





## CLASSIC COLLECTION CLASSIC WHITE

- Frameless cabinet with raised panel doors for classical styling
- Five-piece, solid wood frame doors have a robust mortise and tenon construction
- Solid wood drawers with dovetail joints
- Soft-close door and drawer mechanism
- 6-way adjustable hinges
- 3/4" furniture-grade plywood construction.
- Concealed under-mount drawer glides with full extension
- Two interior metal corner supports on cabinet base
- Durable multi-layered painted drawer fronts and doors
- Matching interior and exterior finish
- Offered with a glass front option (glass and clips not included)
- Decorative trim and molding available, see pages 41-44





## CLASSIC COLLECTION MADURO

- Frameless cabinets with raised panel doors for classical styling
- Five-piece, solid wood frame doors have a robust mortise and tenon construction
- Solid wood drawers with dovetail joints
- Soft-close door and drawer mechanism
- 6-way adjustable hinges
- 3/4" furniture-grade plywood construction
- Concealed under-mount drawer glides with full extension
- Two interior metal corner supports on cabinet base
- Durable multi-layered painted drawer fronts and doors
- Matching interior and exterior finish
- Offered with a glass front option (glass and clips not included)
- Decorative trim and molding available, see pages 41-44





# | URBAN COLLECTION

## CABINETRY THAT BRIDGES A WORLD OF DESIGN AND STYLE

The Urban Collection is masterfully crafted with the utmost attention to detail. Whether it's subtle textures or bold arousing colors, each adds an intriguing depth and visual interest to a room.





# STANDARD FEATURES



Shown: Bayport

Full overlay flat door and corresponding drawer front made of 3/4" eco-friendly furniture board.

Door and drawers are finished with a durable TFL (thermally fused laminate) with matching edge banding.

6-way adjustable soft-close concealed door hinges allow doors to close silently and smoothly.

3/4" thick plywood shelf with six finished sides and four metal shelf clips to withstand heavy items.

Non-toxic surface is safe, durable, and easy to clean.



Interior metal support brackets reinforce corners and create a stable and long-lasting foundation.

Slim 1/2" double-walled metal drawer with a 5/8" plywood bottom and rear panel supports.

Full extension concealed undermount glides support weights up to 75 lbs.

Sturdy 3/4" white plywood box construction with a white TFL interior and exterior finish for clear visibility of cabinet contents.

Full access frameless cabinets allow for ample storage.

Matching toe-kick and side panels sold separately.



KMCA compliant meets and exceeds high industry standards.



Carb 2 compliant certified to meet reduced emission standards for a safe environment.



## URBAN COLLECTION WOODGRAINS

- Solid 3/4" eco-friendly engineered furniture board flat panel doors and drawer fronts
- Doors feature a double-sided "feel wood" surface texture with matching edge-banding
- 6-way adjustable soft-close doors
- Full overlay frameless cabinets
- Non-toxic surface is safe, durable, and easy to clean
- Sturdy 3/4" white plywood box construction
- 3/4" plywood shelves with a 6-sided finish and metal supports
- Slim 1/2" double-walled metal drawer with a 5/8" plywood bottom and rear panel supports
- Full extension concealed undermount drawer glides

Shoreline\*



Black Forest\*



Natural Oak\*

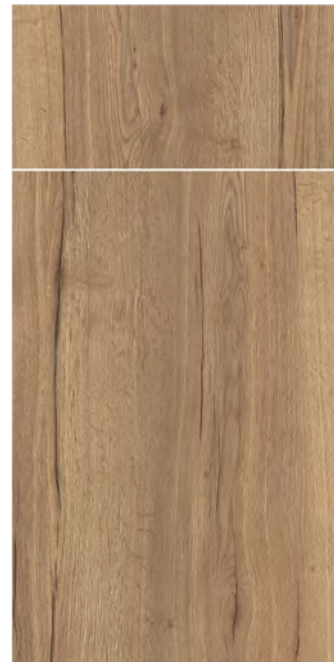

Umbria Elm\*



\*Grain matching is not available.





## URBAN COLLECTION SOLIDS

- Solid 3/4" eco-friendly engineered furniture board flat panel doors and drawer fronts
- Doors feature a single-sided lacquered super-matte finish and matching edge-banding
- 6-way adjustable soft-close doors
- Full overlay frameless cabinets
- Non-toxic surface is safe, durable, and easy to clean
- Sturdy 3/4" white plywood box construction
- 3/4" plywood shelves with a 6-sided finish and metal supports
- Slim 1/2" double-walled metal drawer with a 5/8" plywood bottom and rear panel supports
- Full extension concealed undermount drawer glides

Stone Gray

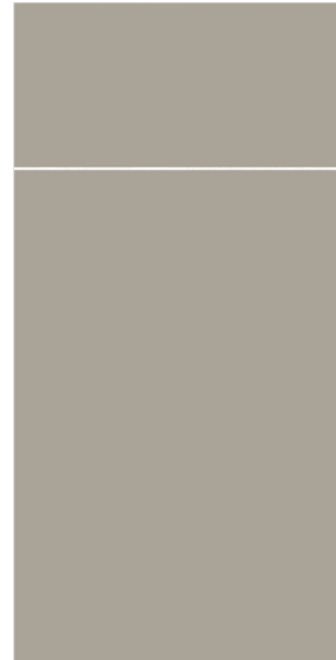

Black Forest



Natural Oak

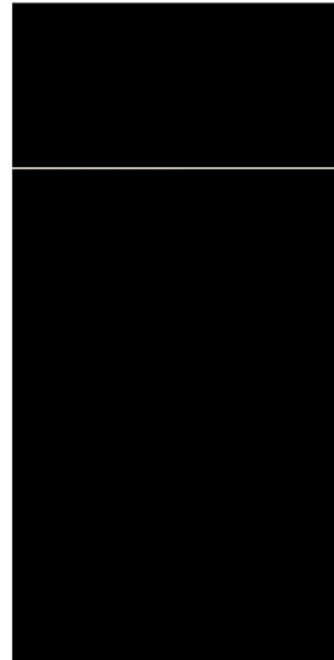



## URBAN COLLECTION HIGH GLOSS

- Solid 3/4" eco-friendly furniture board flat panel doors and drawer fronts
- Doors feature a a single-sided, distortion-free gloss finish with matching edge-banding
- 6-way adjustable soft-close doors
- Full overlay frameless cabinets
- Non-toxic surface is safe, durable, and easy to clean
- Sturdy 3/4" white plywood box construction
- 3/4" plywood shelves with a 6-sided finish and metal supports
- Slim 1/2" double-walled metal drawer with a 5/8" plywood bottom and rear panel supports
- Full extension concealed undermount drawer glides

Bayport\*

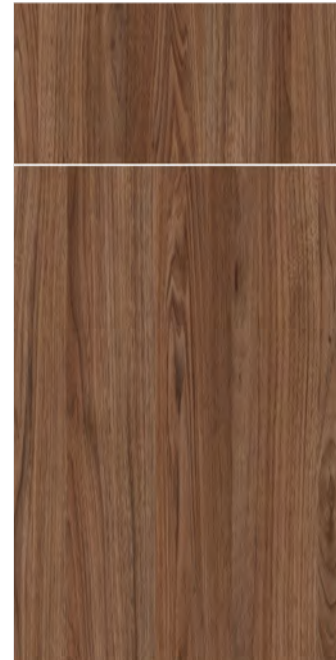

Harbor Gray

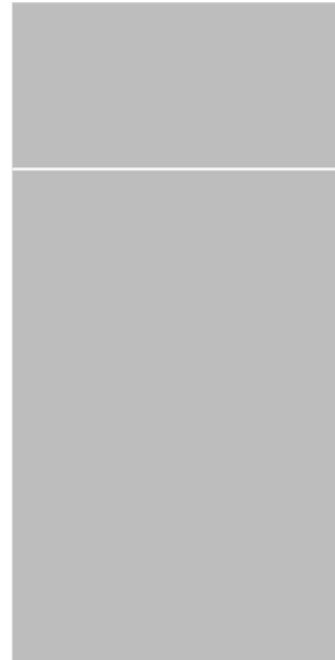

Ultra White



\*Grain matching is not available.





## CLASSIC COLLECTION TREND TEXTURE

- Solid 3/4" eco-friendly furniture board flat panel doors and drawer fronts
- Doors feature a double-sided concrete surface texture and matching edge-banding
- 6-way adjustable soft-close doors
- Full overlay frameless cabinets
- Non-toxic surface is safe, durable, and easy to clean
- Sturdy 3/4" white plywood box construction
- 3/4" plywood shelves with a 6-sided finish and metal supports
- Slim 1/2" double-walled metal drawer with a 5/8" plywood bottom and rear panel supports
- Full extension concealed undermount drawer glides

Concrete Gray



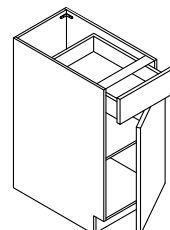

## SPECIFICATIONS GUIDE BASE CABINET

BASE CABINET	CODE	W X H X D	
	B09	09x34.5x24	AVAILABLE IN ALL STYLES
	B12	12x34.5x24	
	B15	15x34.5x24	
	B18	18x34.5x24	
	B21	21x34.5x24	

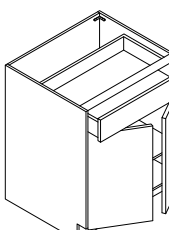
BASE CABINET	CODE	W X H X D	
	B24	24x34.5x24	AVAILABLE IN ALL STYLES
	B27	27x34.5x24	
	B30	30x34.5x24	
	B33	33x34.5x24	
	B36	36x34.5x24	
	B39	39x34.5x24	
	B42	42x34.5x24	

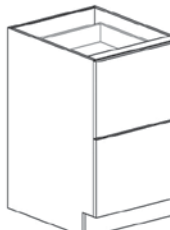
2 DRAWER BASE CABINET*	CODE	W X H X D	
	DB24-2	24x34.5x24	AVAILABLE IN • IMPERIAL BLUE • SHAKER WHITE  *Available in URBAN Color Options  24", 30", & 33" Dallas only.
	DB27-2*	27x34.5x24	
	DB30-2	30x34.5x24	
	DB33-2*	33x34.5x24	
	DB36-2	36x34.5x24	

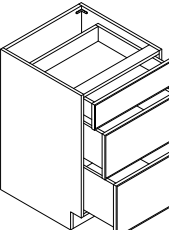
DRAWER BASE CABINET	CODE	W X H X D	
	DB12-3	12x34.5x24	AVAILABLE IN ALL STYLES
	DB15-3	15x34.5x24	
	DB18-3	18x34.5x24	
	DB21-3	21x34.5x24	
	DB24-3	24x34.5x24	
	DB27-3	27x34.5x24	
	DB30-3	30x34.5x24	
	DB33-3	33x34.5x24	
	DB36-3	36x34.5x24	

## SPECIFICATIONS GUIDE BASE CABINET

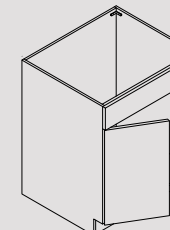
SINK BASE CABINET	CODE	W X H X D	
	SB24	24x34.5x24	AVAILABLE IN ALL STYLES
	SB27	27x34.5x24	
	SB30	30x34.5x24	
	SB33	33x34.5x24	
	SB36	36x34.5x24	
	SB39	39x34.5x24	
	SB42	42x34.5x24	

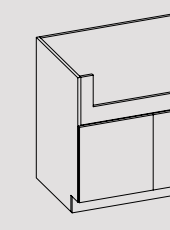
FARM SINK BASE	CODE	W X H X D	
	FSB30	30x34.5x24	AVAILABLE IN ALL STYLES
	FSB33	33x34.5x24	
	FSB36	36x34.5x24	

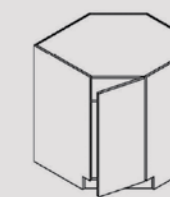
BASE DIAGONAL CABINET	CODE	W X H X D	
	BDC36	36x34.5x24	AVAILABLE IN ALL STYLES  The cabinet may also be used as a corner sink base cabinet with the shelf removed.

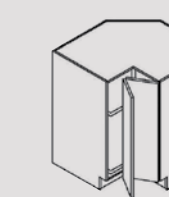
BASE LAZY SUSAN CABINET	CODE	W X H X D	
	BLS33	33x34.5x24	AVAILABLE IN ALL STYLES  Includes metal Lazy Susan insert.
	BLS36	36x34.5x24	

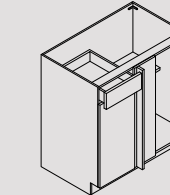
BASE BLIND CORNER CABINET	CODE	W X H X D	
	BBC39	39x34.5x24	AVAILABLE IN ALL STYLES  • Requires return filler. • Includes adjustable half shelf.
	BBC42	42x34.5x24	
	BBC45	45x34.5x24	

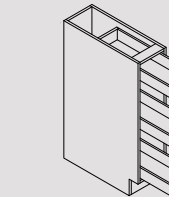
BASE SPICE RACK CABINET	CODE	W X H X D	
	BSR09	09x34.5x24	AVAILABLE IN ALL STYLES  Includes 3 fixed pullout shelves.



## SPECIFICATIONS GUIDE BASE CABINET

### BASE SPICE DRAWER CABINET

CODE W X H X D

BSDC06\* 06x34.5x24

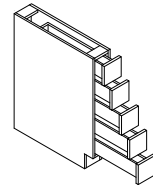

#### AVAILABLE IN

- CLASSIC WHITE
- IMPERIAL BLUE
- PEARL WHITE
- SHAKER WHITE
- STORM GRAY

Fitted drawers do not require nor include glides.

### BASE END ANGLE CABINET

CODE W X H X D

BEA12L 12x34.5x24

BEA12R 12x34.5x24

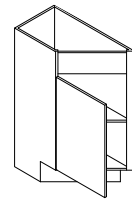

#### AVAILABLE IN

- CLASSIC WHITE
- IMPERIAL BLUE
- PEARL WHITE
- SHAKER WHITE
- STORM GRAY

### BASE END OPEN SHELF

CODE W X H X D

BOES12L 12x34.5x24

BOES12R 12x34.5x24

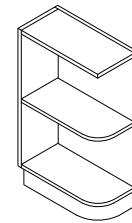

#### AVAILABLE IN

- CLASSIC WHITE
- IMPERIAL BLUE
- PEARL WHITE
- SHAKER WHITE
- STORM GRAY

Includes 2 fixed shelves.

### VANITY BASE SINK CABINET

CODE W X H X D

VSB24 24x34.5x21

VSB30 30x34.5x21

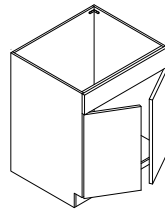

#### AVAILABLE IN ALL STYLES

### VANITY BASE SINK CABINET

CODE W X H X D

VDB12-3 12x34.5x21

VDB15-3 15x34.5x21

VDB18-3 18x34.5x21

VDB24-3\* 18x34.5x21

VDB24-3\* 18x34.5x21

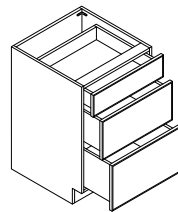

#### AVAILABLE IN ALL STYLES

\*Available in URBAN Color Options

2-1/4" clearance between drawer and back panel.

### VANITY KNEE DRAWER

CODE W X H X D

VKD24 24x07x21

VKD30 30x07x21

VKD36 36x07x21

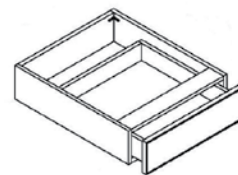

#### AVAILABLE IN ALL STYLES

Includes soft-close extension glides.

## SPECIFICATIONS GUIDE TALL CABINET

### SINGLE DOOR PANTRY CABINET

CODE W X H X D

PC1884 18x84x24

PC1890 18x90x24

PC1896 18x96x24

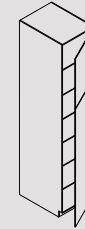

#### AVAILABLE IN ALL STYLES

84" - 6 Shelves, 2 fixed 4 adjustable.

90" & 96" - 7 Shelves, 2 fixed 5 adjustable.

Rollout trays available on pg. 31

### DOUBLE DOOR PANTRY CABINET

CODE W X H X D

PC2484 24x84x24

PC2490 24x90x24

PC2496 24x96x24

PC3084\* 30x84x24

PC3090 30x90x24

PC3096 30x96x24



#### AVAILABLE IN ALL STYLES

84" - 6 Shelves, 2 fixed 4 adjustable

90" & 96" - Shelves, 2 fixed 5 adjustable.

Rollout trays available on pg. 31

### DOUBLE OVEN CABINET

CODE W X H X D

DOC3084 30x84x24

DOC3090 30x90x24

DOC3096 30x96x24

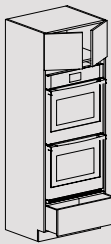

#### AVAILABLE IN ALL STYLES

- DOC can be used for single oven. Ask Innovation Cabinetry for details.
- Trim included for 27" appliance.



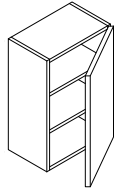

## SPECIFICATIONS GUIDE WALL CABINET

CABINET 30" TALL	CODE	W X H X D	
	W0930	09x30x12	<b>AVAILABLE IN ALL STYLES</b> Includes 2 adjustable shelves.
	W1230	12x30x12	
	W1530	15x30x12	
	W1830	18x30x12	
	W2130	21x30x12	

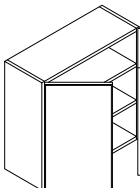
WALL CABINET 30" TALL	CODE	W X H X D	
	W2430	24x30x12	<b>AVAILABLE IN ALL STYLES</b> Includes 2 adjustable shelves.
	W2730	27x30x12	
	W3030	30x30x12	
	W3330	33x30x12	
	W3630	36x30x12	

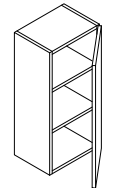
WALL CABINET 36" TALL	CODE	W X H X D	
	W0936	09x36x12	<b>AVAILABLE IN ALL STYLES</b> Includes 2 adjustable shelves.
	W1236	12x36x12	
	W1536	15x36x12	
	W1836	18x36x12	
	W2136	21x36x12	

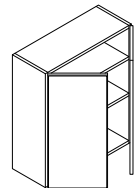
WALL CABINET 36" TALL	CODE	W X H X D	
	W2436	24x36x12	<b>AVAILABLE IN ALL STYLES</b> Includes 2 adjustable shelves.
	W2736	27x36x12	
	W3036	30x36x12	
	W3336	33x36x12	
	W3636	36x36x12	

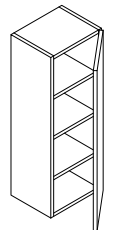
WALL CABINET 42" TALL	CODE	W X H X D	
	W0942	09x42x12	<b>AVAILABLE IN ALL STYLES</b> Includes 3 adjustable shelves.
	W1242	12x42x12	
	W1542	15x42x12	
	W1842	18x42x12	
	W2142	21x42x12	

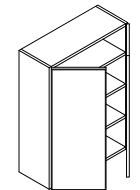
WALL CABINET 42" TALL	CODE	W X H X D	
	W2442	24x42x12	<b>AVAILABLE IN ALL STYLES</b> Includes 3 adjustable shelves.
	W2742	27x42x12	
	W3042	30x42x12	
	W3342	33x42x12	
	W3642	36x42x12	

## SPECIFICATIONS GUIDE WALL CABINET

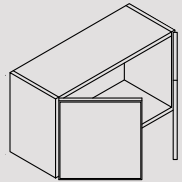
WALL CABINET 24" WIDE	CODE	W X H X D	
	W2412	24x12x12	<b>AVAILABLE IN</b> • CLASSIC WHITE • IMPERIAL BLUE • MADURO • PEARL WHITE • SHAKER WHITE • STORM GRAY
	W2415	24x15x12	
	W2418	24x18x12	

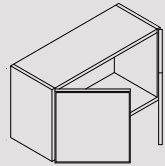
WALL CABINET 30" WIDE	CODE	W X H X D	
	W3012	30x12x12	<b>AVAILABLE IN ALL STYLES</b>
	W3015	30x15x12	
	W3018	30x18x12	
	W3021	30x21x12	
	W3024	30x24x12	

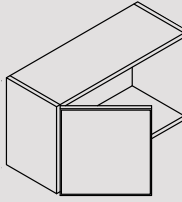
WALL CABINET 36" WIDE	CODE	W X H X D	
	W3612	36x12x12	<b>AVAILABLE IN ALL STYLES</b>
	W3615	36x15x12	
	W3618	36x18x12	
	W3621	36x21x12	
	W3624	36x24x12	

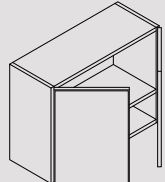
WALL CABINET 24" TALL	CODE	W X H X D	
	W2424*	24x24x12	<b>AVAILABLE IN ALL STYLES</b> *Not available in URBAN Color Options.
	W3024*	30x24x12	
	W3624	36x24x12	
	W3624	36x24x12	

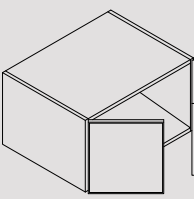
WALL CABINET 24" DEEP	CODE	W X H X D	
	W3012-24	30x12x24	<b>AVAILABLE IN ALL STYLES</b> *Not available in URBAN Color Options.
	W3018-24	30x18x24	
	W3612-24	36x12x24	
	W3615-24	36x15x24	
	W3618-24	36x18x24	
	W3621-24*	36x21x24	

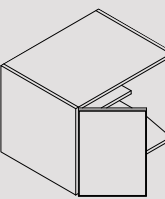
WALL CABINET 24" DEEP	CODE	W X H X D	
	W3024-24	30x24x24	<b>AVAILABLE IN ALL STYLES</b> Includes one half-shelf.
	W3624-24	30x24x24	

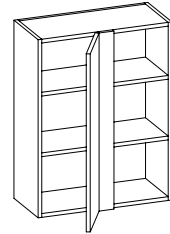

## SPECIFICATIONS GUIDE WALL CABINET

WALL BLIND CABINET 27" WIDE	CODE	W X H X D	AVAILABLE IN
	WBC2730	27x30x12	• ULTRA WHITE
	WBC2736	27x36x12	
	WBC2742	27x42x12	

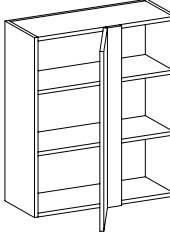
WALL BLIND CABINET 30" WIDE	CODE	W X H X D	AVAILABLE IN
	WBC3030	30x30x12	• URBAN Color Options
	WBC3036	30x36x12	
	WBC3042	30x42x12	

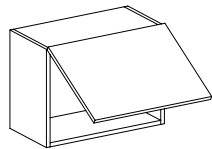
HORIZONTAL WALL CABINET 24" WIDE	CODE	W X H X D	AVAILABLE IN
	W2412-HK	24x12x12	• URBAN Color Options
	W2415-HK	24x15x12	
	W2418-HK	24x18x12	
	W2421-HK	24x21x12	

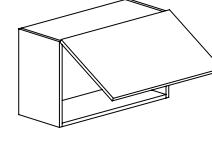
HORIZONTAL WALL CABINET 30" WIDE	CODE	W X H X D	AVAILABLE IN
	W3012-HK	30x12x12	• URBAN Color Options
	W3015-HK	30x15x12	
	W3018-HK	30x18x12	
	W3021-HK	30x21x12	

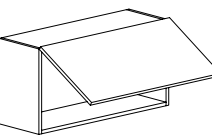
HORIZONTAL WALL CABINET 36" WIDE	CODE	W X H X D	AVAILABLE IN
	W3612-HK	36x12x12	• URBAN Color Options
	W3615-HK	36x15x12	
	W3618-HK	36x18x12	
	W3621-HK	36x21x12	

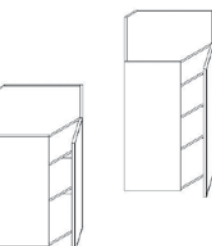
WALL DIAGONAL CABINET 24" WIDE	CODE	W X H X D	AVAILABLE IN
	WDC2412	24x12x12	<ul style="list-style-type: none"> <li>• CLASSIC WHITE</li> <li>• IMPERIAL BLUE</li> <li>• PEARL WHITE</li> <li>• SHAKER WHITE</li> <li>• STORM GRAY</li> </ul> 12, 18 & 24 no shelf 30" & 36" includes 2 shelves 42" includes 3 shelves.
	WDC2418	24x18x12	
	WDC2424*	24x24x12	
	WDC2430	24x30x12	
	WDC2436	24x36x12	
	WDC2442	24x42x12	

## SPECIFICATIONS GUIDE WALL CABINET

WALL END ANGLE CABINET	CODE	W X H X D	AVAILABLE IN
	WEA1230	12x30x12	<ul style="list-style-type: none"> <li>• CLASSIC WHITE</li> <li>• IMPERIAL BLUE</li> <li>• PEARL WHITE</li> <li>• SHAKER WHITE</li> <li>• STORM GRAY</li> </ul>
	WEA1236	12x36x12	
	WEA1242	12x42x12	

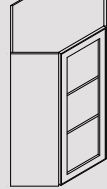
WALL DIAGONAL MULLION DOOR	CODE	W X H X D	AVAILABLE IN
	WDCMD2430	24x30x12	<ul style="list-style-type: none"> <li>• CLASSIC WHITE</li> <li>• IMPERIAL BLUE</li> <li>• MADURO</li> <li>• PEARL WHITE</li> <li>• SHAKER WHITE</li> <li>• STORM GRAY</li> </ul> 30" & 36" includes 2 shelves. 42" includes 3 shelves.
	WDCMD2436	24x36x12	
	WDCMD2442	24x42x12	

All WDCMD cabinets are sold as a kit containing a standard wall cabinet and a separate door that will accommodate glass. Glass and clips, not included.

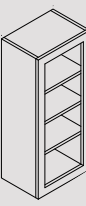
WALL MULLION DOOR 42" TALL	CODE	W X H X D	AVAILABLE IN
	WMD1242	12x42x12	<ul style="list-style-type: none"> <li>• CLASSIC WHITE</li> <li>• IMPERIAL BLUE</li> <li>• MADURO</li> <li>• PEARL WHITE</li> <li>• SHAKER WHITE</li> <li>• STORM GRAY</li> </ul>
	WMD1542	15x42x12	
	WMD1842	18x42x12	

All WMD cabinets are sold as a kit containing a standard wall cabinet and a separate door that will accommodate glass. Glass and clips, not included.

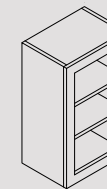
WALL MULLION DOOR 30" TALL	CODE	W X H X D	AVAILABLE IN
	WMD1230	12x30x12	<ul style="list-style-type: none"> <li>• CLASSIC WHITE</li> <li>• IMPERIAL BLUE</li> <li>• MADURO</li> <li>• PEARL WHITE</li> <li>• SHAKER WHITE</li> <li>• STORM GRAY</li> </ul>
	WMD1530	15x30x12	
	WMD1830	18x30x12	

All WMD cabinets are sold as a kit containing a standard wall cabinet and a separate door that will accommodate glass. Glass and clips, not included.

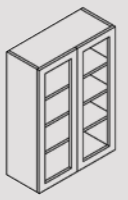
WALL MULLION DOOR 42" TALL	CODE	W X H X D	AVAILABLE IN
	WMD2442	24x42x12	<ul style="list-style-type: none"> <li>• CLASSIC WHITE</li> <li>• IMPERIAL BLUE</li> <li>• MADURO</li> <li>• PEARL WHITE</li> <li>• SHAKER WHITE</li> <li>• STORM GRAY</li> </ul>
	WMD3042	30x42x12	
	WMD3642	36x42x12	

All WMD cabinets are sold as a kit containing a standard wall cabinet and a separate door that will accommodate glass. Glass and clips, not included.

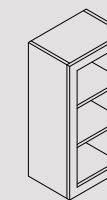
WALL MULLION DOOR 36" TALL	CODE	W X H X D	AVAILABLE IN
	WMD1236	12x36x12	<ul style="list-style-type: none"> <li>• CLASSIC WHITE</li> <li>• IMPERIAL BLUE</li> <li>• MADURO</li> <li>• PEARL WHITE</li> <li>• SHAKER WHITE</li> <li>• STORM GRAY</li> </ul>
	WMD1536	15x36x12	
	WMD1836	18x36x12	

All WMD cabinets are sold as a kit containing a standard wall cabinet and a separate door that will accommodate glass. Glass and clips, not included.



# SPECIFICATIONS GUIDE WALL CABINET

## ALL MULLION DOOR 30" TALL

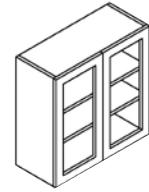

CODE	W X H X D
WMD2430	24x30x12
WMD3030	30x30x12
WMD3630	36x30x12

### AVAILABLE IN

- CLASSIC WHITE
- IMPERIAL BLUE
- MADURO
- PEARL WHITE
- SHAKER WHITE
- STORM GRAY

All WMD cabinets are sold as a kit containing a standard wall cabinet and a separate door that will accommodate glass. Glass and clips, not included.

## WALL OPEN END SHELF 12" WIDE



CODE	W X H X D
WOES1230	12x30x12
WOES1236	12x36x12
WOES1242*	12x42x12

### AVAILABLE IN

- CLASSIC WHITE
- IMPERIAL BLUE
- MADURO
- PEARL WHITE
- SHAKER WHITE
- STORM GRAY

30" & 36" Includes 2 shelves.  
42" Includes 3 shelves.

## WINE RACK X-STYLE

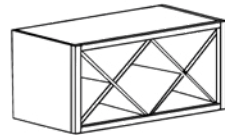

CODE	W X H X D
WSC3018	30x18x12
WSC3618	36x18x12

### AVAILABLE IN

- CLASSIC WHITE
- IMPERIAL BLUE
- MADURO
- SHAKER WHITE
- STORM GRAY

## WALL MULLION DOOR 36" TALL

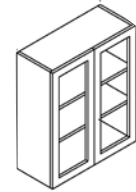

CODE	W X H X D
WMD2436	24x36x12
WMD3036	30x36x12
WMD3636	36x36x12

### AVAILABLE IN

- CLASSIC WHITE
- IMPERIAL BLUE
- MADURO
- PEARL WHITE
- SHAKER WHITE
- STORM GRAY

All WMD cabinets are sold as a kit containing a standard wall cabinet and a separate door that will accommodate glass. Glass and clips, not included.

## WALL OPEN END SHELF 6" WIDE

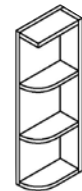

CODE	W X H X D
WOES0630	06x30x12
WOES0636	06x36x12
WOES0642	06x42x12

### AVAILABLE IN

- CLASSIC WHITE
- IMPERIAL BLUE
- MADURO
- PEARL WHITE
- SHAKER WHITE
- STORM GRAY

30" & 36" includes two shelves.

42" includes 3 shelves.  
Must specify right or left.

## WALL SMALL DRAWER CABINET

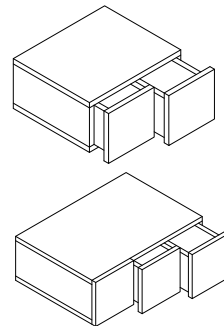

CODE	W X H X D
WSD1206-2	12x06x12
WSD1806-3	18x06x12

### AVAILABLE IN

- CLASSIC WHITE
- IMPERIAL BLUE
- MADURO
- SHAKER WHITE
- STORM GRAY

Fitted drawers do not require nor include glides.





# SPECIFICATIONS GUIDE ACCESSORY & MOLDING

## VANITY KNEE DRAWER

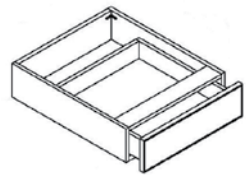

CODE W X H X D

VKD24	24x07x21
VKD30	30x07x21
VKD36	36x07x21

### AVAILABLE IN ALL STYLES

Includes soft-close extension glides.

## SOLID WOOD ROLL-OUT TRAY

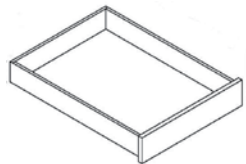

CODE W X H X D

H-ROT15	9.75X4.125X20
H-ROT18	12.75X4.125X20
H-ROT21	15.75X4.125X20
H-ROT24	18.75X4.125X20
H-ROT27	27X4.125X20
H-ROT30	24.75X4.125X20
H-ROT33	27.75X4.125X20
H-ROT36	30.75X4.125X20

### NATURAL WOOD FINISH

Includes soft-close extension guides.

## CABINET DOOR PANEL

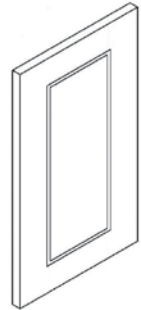

CODE W X H X D

D1230	12x30x.75
D1236	12x36x.75
D1242	12x42x.75
D1530	15x30x.75
D1536	15x36x.75
D1542	15x42x.75
D2430	24x30x.75

### AVAILABLE IN ALL STYLES

## FINISHED PANEL



CODE W X H X D

PNL2496	24x96x.75
PNL3596	35x96x.75
PNL4896	48x96x.75
DWPNL*	24x35x.75

### AVAILABLE IN ALL STYLES

Edge-banding on all sides.

\*DWPNL has toe-kick notch and no return.

# SPECIFICATIONS GUIDE ACCESSORY & MOLDING

## CORBEL - SQUARE



CODE W X H X D

SQCOR3	4x12x4
--------	--------

### AVAILABLE IN

- CLASSIC WHITE
- IMPERIAL BLUE
- MADURO
- PEARL WHITE
- SHAKER WHITE
- STORM GRAY

## FILLER



CODE W X H X D

WF196*	01x96 x.75
WF296*	02x96x.75
WF330	03x30x.75
WF336	03x36x.75
WF342	03x42x.75
WF396	03x96x.75
WF630	06x30x.75
WF636	06x36x.75
WF642	06x42x.75
WF696	06x96x.75

### AVAILABLE IN ALL STYLES

\*Ultra White only.

Edge-banded on all sides.

## SQUARE SPOOL



CODE W X H X D

SQSPL3	3.5x34.5x3.5
--------	--------------

### AVAILABLE IN

- CLASSIC WHITE
- IMPERIAL BLUE
- MADURO
- PEARL WHITE
- SHAKER WHITE
- STORM GRAY

## FLUTED FILLER



CODE W X H X D

RWFC330	03x30x.75
RWFC336	03x36x.75
RWFC342	03x42x.75
RWFC396	03x96x.75

### AVAILABLE IN

- CLASSIC WHITE
- IMPERIAL BLUE
- MADURO
- PEARL WHITE
- SHAKER WHITE
- STORM GRAY

Fluted filler includes 2 Plinth Blocks.

Fluted Filler sold separately, add an N to the item code-RWFC396N

## PLINTH BLOCK APPLIQUE



CODE W X H X D

PBAFFB	03x04x.375
--------	------------

### AVAILABLE IN

- CLASSIC WHITE
- IMPERIAL BLUE
- MADURO
- SHAKER WHITE
- STORM GRAY

Applique has (3) raised ribs on back, intended to be used with RWFC Fluted Filler.



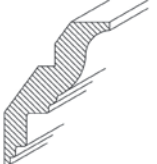

# SPECIFICATIONS GUIDE ACCESSORY & MOLDING

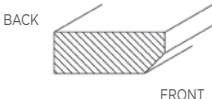
CLASSIC CROWN MOLDING	CODE	W X H X D
	CCM8	2.375x3.25x96
<b>AVAILABLE IN</b> <ul style="list-style-type: none"> <li>• CLASSIC WHITE</li> <li>• MADURO</li> <li>• SHAKER WHITE</li> </ul>		

COUNTER TOP MOLDING	CODE	W X H X D
	CTM8	02x.75x96
<b>AVAILABLE IN</b> <ul style="list-style-type: none"> <li>• CLASSIC WHITE</li> <li>• IMPERIAL BLUE</li> <li>• PEARL WHITE</li> <li>• SHAKER WHITE</li> <li>• STORM GRAY</li> </ul>		

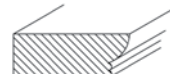
ANGLED CROWN MOLDING	CODE	W X H X D
	ACM8	03x03x96
<b>AVAILABLE IN</b> <ul style="list-style-type: none"> <li>• CLASSIC WHITE</li> <li>• IMPERIAL BLUE</li> <li>• PEARL WHITE</li> <li>• STORM GRAY</li> <li>• SHAKER WHITE</li> </ul>		

OGEE MOLDING	CODE	W X H X D
	OGM8	02x.75x96
<b>AVAILABLE IN</b> <ul style="list-style-type: none"> <li>• CLASSIC WHITE</li> <li>• SHAKER WHITE</li> <li>• MADURO</li> </ul>		

COVE MOLDING	CODE	W X H X D
	CVM8	5x3.5x96
<b>AVAILABLE IN</b> <ul style="list-style-type: none"> <li>• CLASSIC WHITE</li> <li>• IMPERIAL BLUE</li> <li>• PEARL WHITE</li> <li>• SHAKER WHITE</li> <li>• STORM GRAY</li> </ul>		

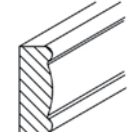
LIGHT RAIL MOLDING	CODE	W X H X D
	IV18	02x.75x96
<b>AVAILABLE IN</b> <ul style="list-style-type: none"> <li>• CLASSIC WHITE</li> <li>• MADURO</li> <li>• SHAKER WHITE</li> </ul>		

# SPECIFICATIONS GUIDE ACCESSORY & MOLDING

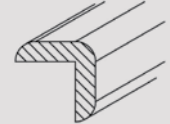
OUTSIDE CORNER MOLDING	CODE	W X H X D
	OCM8*	.875x.875x96
<b>AVAILABLE IN</b> <ul style="list-style-type: none"> <li>• CLASSIC WHITE</li> <li>• IMPERIAL BLUE</li> <li>• MADURO</li> <li>• PEARL WHITE</li> <li>• SHAKER WHITE</li> <li>• STORM GRAY</li> </ul>		

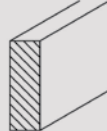
SQUARE SCRIBE MOLDING	CODE	W X H X D
	SQSM8	.25x.75x96
<b>AVAILABLE IN</b> <ul style="list-style-type: none"> <li>• CLASSIC WHITE</li> <li>• IMPERIAL BLUE</li> <li>• MADURO</li> <li>• PEARL WHITE</li> <li>• SHAKER WHITE</li> <li>• STORM GRAY</li> </ul>		

QUARTER ROUND MOLDING	CODE	W X H X D
	QR8*	.75x.75x96
<b>AVAILABLE IN</b> <ul style="list-style-type: none"> <li>• CLASSIC WHITE</li> <li>• IMPERIAL BLUE</li> <li>• MADURO</li> <li>• PEARL WHITE</li> <li>• SHAKER WHITE</li> <li>• STORM GRAY</li> </ul>		

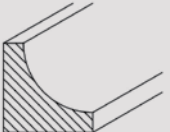
INSIDE CORNER TRIM	CODE	W X H X D
	ICT8*	.75x.75x96
<b>AVAILABLE IN</b> <ul style="list-style-type: none"> <li>• CLASSIC WHITE</li> <li>• IMPERIAL BLUE</li> <li>• PEARL WHITE</li> <li>• SHAKER WHITE</li> <li>• STORM GRAY</li> </ul>		

SCRIBE MOLDING	CODE	W X H X D
	SM8*	.75x.25x96
<b>AVAILABLE IN</b> <ul style="list-style-type: none"> <li>• CLASSIC WHITE</li> <li>• IMPERIAL BLUE</li> <li>• MADURO</li> <li>• PEARL WHITE</li> <li>• SHAKER WHITE</li> <li>• STORM GRAY</li> </ul>		

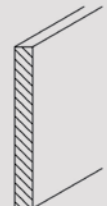
TOE KICK MOLDING	CODE	W X H X D
	TK8	.50x4.5x96
<b>AVAILABLE IN ALL STYLES</b> <ul style="list-style-type: none"> <li>• Made of .5" plywood.</li> <li>• Sides are edge-banded.</li> </ul>		



# INFORMATION

## DISCLAIMER FOR PAINTED WOOD CABINETY

Please be aware that wood expands and contracts. When this natural process occurs on painted cabinetry, it will create an open joint in the painted finish. An open joint line is not a defect, and it is known and accepted in the cabinet industry. The finish will still protect the surface, and the joint's structural integrity will not be affected. Every manufacturer of painted all-wood cabinets shares these issues. They are not unique to Innovation Cabinetry. Wood may expand and contract differently from cabinet to cabinet. Even joints within the same cabinet may behave differently. Some joined wood may not show any joint lines, others may be slightly visible, and others may display visible joint lines on day one of installation.

Joint lines also may occur due to the repeated impacts from regular, everyday use. To avoid damage to an exposed open wood joint due to water or heavy moisture exposure, remove any excess moisture from cabinet surfaces as soon as possible. Discolorations: All paints, especially lighter colors, are susceptible to discoloration due to airborne particles from cooking, grilling, tobacco smoke, fireplaces, or candles. Prolonged exposure to natural or artificial light may also alter the finish color.

## DISCLAIMER FOR STAINED WOOD CABINETY

All wood is a product of nature. While each wood type grows best in specific conditions, nature provides differences critical to the growth. As a result, soil and weather conditions will affect grain patterns and colors. The beauty of real wood is created by the infinite variation of grain, texture, and color.

This is especially true of hardwood and hardwood veneers. It is the nature of hardwoods to have mineral streaks and significant variation in graining. Colors range from light brown, dark brown and even black areas in the wood. Since the number of mineral lines varies from board to board, you may notice the difference between cabinets, doors, drawers, or even on the same panel. Mineral streaks or unusual graining are considered natural wood characteristics and will not be considered a defect or reason for replacement.

No particular emphasis is made to select materials to match each color. All color characteristics of the wood will change as it ages. This aging process will gradually change the color of the wood and the stain. The amount and rate of change will depend on many factors, including wood-type, stain color, and direct sunlight. Also, exposure to smoke, chemicals, and indoor lighting may cause some materials to vary from their original color over time. The softening color change is why cabinets or accessories added later may not match precisely to the previously installed cabinetry.

For this reason, door samples and displays may not be the same color as the cabinets you receive. Innovation Cabinetry cannot be responsible for the naturally occurring changes in your wood cabinets.

## GENERAL CARE

A soft cotton cloth dampened with warm water is usually sufficient to clean your cabinets. If more thorough cleaning is required, use one of the following cleaning solutions:

- A fresh solution of mild dish washing liquid mixed with warm water.
- A mild all-purpose cleaner that does not contain ammonia or silicone.

Use the mildest cleaning solution available to clean your cabinets successfully. Stronger products may damage or discolor your cabinet finish and void your warranty. After cleaning, dry immediately using a clean/ dry cotton cloth.

**CLEANING PRODUCTS TO AVOID** - Avoid using the following cleaning products on your cabinets:

- Harsh chemicals
- Abrasive cleaning products include tub/ sink cleansers, scouring powder, scouring pads, or steel wool.
- Sponges or dish cloths. (They may contain particles that could scratch your cabinets or stain food or oil residue)
- Ammonia or ammonia-based cleaning products.
- Bleach or bleach-based cleaning products.
- Silicone-based cleaning, waxing, or polishing products.

**SPLATTERS AND SPILLS** - Clean spills and splatters immediately. Prolonged exposure to spills, including food, water, or other liquids, or to oil and grease splatters can cause permanent discoloration or damage to your cabinet's finish.

**REGULAR DUSTING** - Use a clean/ dry soft cotton cloth for regular dusting. Do not use pre-moistened dusting sheets or aerosol products made for dusting.

**CLEANING GLASS DOORS** - Extra care is required when cleaning glass doors. Spray an ammonia-free glass cleaner on a clean cotton cloth or paper towel. Do not spray cleaner directly on the glass. The spray could run or seep behind the frame or mullions and cause damage.

**WAXING & POLISHING** - Waxing is not recommended. Over time, waxing and polishing compounds may build up on the surface of your cabinet, causing a hazy, streaky, or yellowed appearance to your cabinet's finish.

**SCRATCHES, GOUGES & NICKS** - Touch-Up Kits are available to hide surface damage. Contact Innovation Cabinetry to purchase the color-matched touch-up kit for your cabinets. Use the kit's touch-up pen to hide minor blemishes. Use the kit's tinted putty to fill deeper scratches, gouges, or nicks.

**AVOID MOISTURE DAMAGE** - Avoid draping damp clothes or dish clothes over cabinet doors. This moisture can cause permanent damage, including but not limited to peeling and discoloration of the cabinet's finish.

**AVOID LIGHT DAMAGE** - Exposure to direct sunlight tends to darken the color of natural wood products. Sunlight can also fade painted wood surfaces. Consider using draperies or blinds to protect your cabinets from direct sunlight.

**AVOID HEAT DAMAGE** - The heat generated when using an oven's self-cleaning feature is much greater than the heat of regular cooking. If this heat escapes from the oven, it can damage your cabinets. While this is a rare circumstance, you can minimize the risk of cabinet damage by removing cabinet doors and drawers nearest the oven before using its self-cleaning feature.

For additional care and cleaning information visit [www.innovationcabinetry.com](http://www.innovationcabinetry.com)





# WARRANTY & RETURNS

## TEN-YEAR LIMITED

Innovation Cabinetry, LLC warrants to the original residential end-user that cabinetry and all hardware products shall be free from defects in material and workmanship under everyday use for ten (10) years from the date of shipment. This Warranty is only applicable to products used in residential applications within the United States and is nontransferable to subsequent end-users or owners. Should defects in material exist or occur during the warranty period, Innovation Cabinetry, LLC, at its sole discretion, will either (1) repair or replace the defective component free of charge or (2) refund the purchase price of the defective component. This Warranty covers only materials and components of products supplied by Innovation Cabinetry, LLC. This Warranty does not cover costs or labor to remove and reinstall countertops, appliances, plumbing fixtures, electrical outlets, etc. This Warranty shall become void if the cabinets are in any way modified, improperly installed, or damaged before or during the installation process. This Warranty shall become void if products utilized in any application other than the common uses for residential cabinetry. Furthermore, this Warranty will not apply to cabinets damaged by misuse, neglect, abuse, acts of God, exposure to moisture, exposure to extreme temperatures, or the effects of normal wear and tear. Natural woods vary in color and characteristics and will exhibit subtle changes as they age. Sunlight, smoke, household cleaners, and other environmental conditions may also affect the color over time. Color and wood characteristics are considered the nature of the material related to their environment and exposures and not covered under this Warranty. Innovation Cabinetry, LLC reserves the right to alter design, specifications, and material without obligation to make similar changes to products previously manufactured. The repair(s) or replacement(s) is contingent upon the current product offering of style and construction within the Innovation Cabinetry, LLC product line at the time of the Warranty claim. If a warranty claim is filed after a product becomes obsolete, Innovation Cabinetry, LLC reserves the right to honor the Warranty in one of the following fashions:

- To replace the affected component with a new component of the same style.
- To replace the affected component and any other component(s) in the residential application to achieve a reasonably uniform appearance with a similar and comparable product style of the originally purchased style.
- Refund the purchase price of the defective component. Innovation Cabinetry, LLC cannot guarantee that these replacements will match the original components' finish and appearance in the residential application. This is due to natural variations and the changes that occur during the woods' natural aging process, affecting its color and grain.

THE LIMITED WARRANTY IS THE EXCLUSIVE WARRANTY OF INNOVATION CABINETRY, LLC. THIS LIMITED WARRANTY IS EXTENDED IN LIEU OF AND

TO THE EXCLUSION OF ALL OTHER WARRANTIES, EXPRESS, IMPLIED, OR STATUTORY, INCLUDING ANY IMPLIED WARRANTY OF MERCHANTABILITY OR FITNESS FOR A PARTICULAR PURPOSE. IN NO EVENT SHALL INNOVATION CABINETRY, LLC'S LIABILITY EXCEED THE BUYER'S PURCHASE PRICE. THE LIMITED WARRANTY RUNS ONLY TO THE ORIGINAL END-USER OF THE PRODUCTS. THE LIMITED WARRANTY IS NOT INTENDED TO, AND DOES NOT, RUN TO ANY SUBSEQUENT BUYER OR END-USER, NOR TRANSFERRED TO ANY OTHER PERSON, UNLESS OTHERWISE SPECIFICALLY STATED IN WRITING BY AN OFFICER OF INNOVATION CABINETRY, LLC. IN NO EVENT SHALL INNOVATION CABINETRY, LLC BE LIABLE TO THE END-USER OR ANY THIRD PARTY FOR SPECIAL, COLLATERAL, INCIDENTAL, CONSEQUENTIAL, OR PUNITIVE DAMAGES.

This Warranty gives you specific legal rights, and you may have other rights, which vary from state to state. Some states do not exclude or limit incidental or consequential damages, so the above limitations or exclusions may not apply. To make a warranty claim, you must first contact your authorized Innovation Cabinetry, LLC dealer, contractor, or distributor, who will arrange for an inspection of the cabinetry products. Innovation Cabinetry, LLC must verify the date of purchase and products purchased to extend the Warranty's benefits. It is highly recommended you retain receipts for product purchases. Thank you for your purchase of Innovation Cabinetry, LLC's high-quality cabinetry products! We trust that our products will bring you many years of outstanding service and appearance.

## RETURN POLICY

Returns or exchanges must be made within 30 days from the sales order/invoice date, accompanied by a valid Innovation Cabinetry sales order/invoice. Innovation Cabinetry must inspect returns or exchanges before its acceptance for return.

Cabinets must be returned in their unopened, original boxes. Boxes cannot be wet or damaged and must be free of dirt, paint, markers, etc. All hardware must be in its original packing.

Hardware must be free from scratches, dirt, paint, markers, etc. Customized or assembled cabinets cannot be returned under any circumstance. Products damaged in transit shipped by F.O.B. Innovation's warehouse through a freight company cannot be returned to Innovation.\* Innovation Cabinetry reserves all rights to refuse to accept any item for return or refund.

\* Note: To claim loss and damage in transit of products shipped by F.O.B. please refer to Innovation's Transportation Policy and the freight company's claim procedures.





# CUSTOMER CARE

## FOR THE HOMEOWNER

InnovationCabinetry.com

Our website offers many ways to inspire organizational solutions in beautiful cabinetry. Highlights include:

- View inspirational designs and photos
- Visual details of door by style
- Consumer education about wood characteristics, installation, the Diamond Difference, and do's and don'ts of cabinetry care

## FOR DESIGNERS AND DEALERS

InnovationCabinetry.com

If you're not currently registered for InnovationCabinetry.com, you could be missing important product and brand information. It's quick and easy, so visit the site and register today. It will enable you to:

- Place an order
- Download or order product literature, like the product brochure, specification, and price books, ProKitchen and 2020 Design updates
- Order color swatches and door samples, and more from the shopping cart

## INNOVATION CABINETRY CUSTOMER CARE RESOURCES

Electronic means are convenient, but sometimes you just need to talk to a person. At Innovation Cabinetry every account may be assigned a Sales Account Manager who are there to help. Your Sales Account Manager can:

- Place an order
- Follow up on orders or track delivery progress
- Discuss product situations or address invoice questions

Additional assistance is available through Customer Service:

Tampa: 888.206.1088;

Dallas: 888.290.9770

or [customerservice@innovationcabinetry.com](mailto:customerservice@innovationcabinetry.com)

Your Innovation Cabinetry Sales Account Manager is there to help you every step of the way. Make sure to contact them whenever you have questions, concerns, or need information.



Formaldehyde emissions comply with requirements of 24 CFR, Part 3280 (August 9, 1984), the HUD rule on Manufactured Home Construction and Safety Standards and 29 CFR Part 1910 (May 27, 1992), the OSHA rule on Occupational Exposure to Formaldehyde. Formaldehyde emissions for raw engineered wood is restricted to 0.3 parts per million. In keeping with our policy of continuous refinement, Innovation Cabinetry, LLC reserves the right to alter specifications and styles without general notice or obligation to make similar changes in products previously manufactured.



Innovation Cabinetry carries the seal of the Kitchen Cabinet Manufacturers Association (KCMA) Certification Program, which assures that our cabinets meet or exceed the rigorous standards set by the American National Standards Institute (ANSI).



We are a proud member of the National Kitchen & Bath Association (NKBA) a non-profit trade group that promotes professionalism in the kitchen and bath industry.

## ACKNOWLEDGEMENTS:

Page 11 Installation Image by McJunkin Signature Homes LLC

Page 5 Installation Image by Jacob Morgan Construction

Page 15 Installation Image by Accu Building



# INTRODUCING THE NEXT GENERATION OF OUTDOOR \ INDOOR CABINETRY

Innovation Cabinetry is re-imagining and re-defining outdoor living with Endura Outdoor Cabinetry. This durable all-weather cabinetry pairs U.S.A. craftsmanship with cutting-edge innovation for an unparalleled outdoor collection.



**Endura**  
Outdoor-Indoor Cabinetry



View the full outdoor collection at [www.EnduraCabinetry.com](http://www.EnduraCabinetry.com)

Shown: Club profile in Dove and Sedona profile Symphony Blue.





**INNOVATION CABINETRY**

7030 Anderson Road | Tampa, Florida 33634

727-535-7667 | 888-206-1088 | fax 813-884-0007 | [info@innovationcabinetry.com](mailto:info@innovationcabinetry.com)

GET SOCIAL WITH US:

